

Solicor - Chemical Resistance

Solicor-CR is a color-through, lab-grade worksurface that is perfectly suited for both vertical and horizontal applications in environments where chemical resistance, durability *and* aesthetics are top priorities. K-12 and university laboratories, government, research & development facilities medical, pharmaceutical, healthcare, hospitality and retail facilities will all benefit from this new innovation.

Solicor-CR was developed to give designers and builders what they have long asked for - a lightweight, easy-to-fabricate, chemical resistant worksurface that is the same color the entire way through.

That's right - no more black core! Solicor-CR opens up a new world of possibilities for lab design by providing a modern alternative for almost every surface in a workspace.

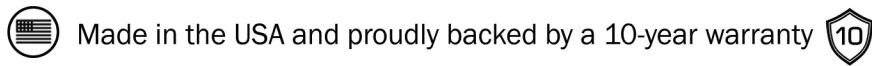

CONTENTS

Product Introduction	1
Material Benefits	2
Product Specifications [Sizes, Weight, Thicknesses, Colors]	3
Materials Comparison Chart	4
Testing Results Data	4
Certifications & Memberships	4
Samples & Orders	4

Open up a new world of lab design.

SOLICOR-CR

worksurfaces

Material Benefits

CHEMICAL RESISTANCE



Solicor-CR sets the industry standard for chemical resistance, providing designers and builders with a robust combination of performance and aesthetics.

FIRE RESISTANCE



Solicor-CR is rated **CLASS A** for fire and heat resistance, yet another attribute aligning it squarely with the laboratory grade market.

MOISTURE RESISTANCE



Moisture resistance, even for the harshest acids, bases, solvents, and any other corrosive in a laboratory environment.

IMPACT & SCRATCH



Solicor-CR outperforms the competition and sets a new standard for scratch and impact resistance. Full testing data available upon request.

USA MADE



Proudly manufactured & fabricated in the USA.

AESTHETIC APPEAL



Black core... No more. Gray compact with a gray core, graphite with graphite core and white with white core - setting a new standard for the ultra-modern lab appearance.

LIGHTWEIGHT



Solicor-CR worksurfaces are light enough to be recommended for both horizontal and vertical applications. Experience exceptional strength without all the weight.

EASY TO INSTALL



At 7.4 lbs per square foot, the lightweight Solicor-CR is easy to transport, modify and install on the jobsite.

COST-EFFECTIVE



Solicor-CR is cost advantageous, often requiring less upfront expense as well as lower life cycle costs. Guaranteed by our industry-best 10-year warranty.

UV LIGHT RESISTANCE



Using ultraviolet light to test prolonged exposure to direct sunlight, Solicor-CR coloration experienced unnoticeable variance from start to finish.



SOLICOR-CR

worksurfaces

Size | Thickness | Weight | Color

SHEET SIZE AVAILABLE IN 5' X 10'

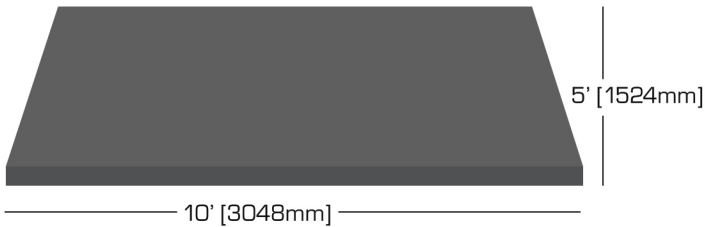

THICKNESSES AVAILABLE IN 1.0", 0.75", 0.5" & 0.375"

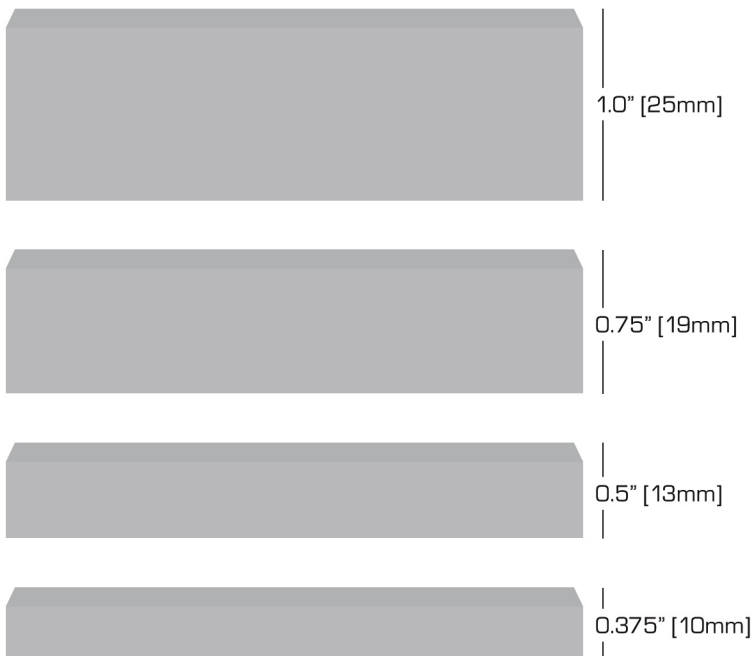

INITIAL COLOR AVAILABILITY IN GRAPHITE & GRAY

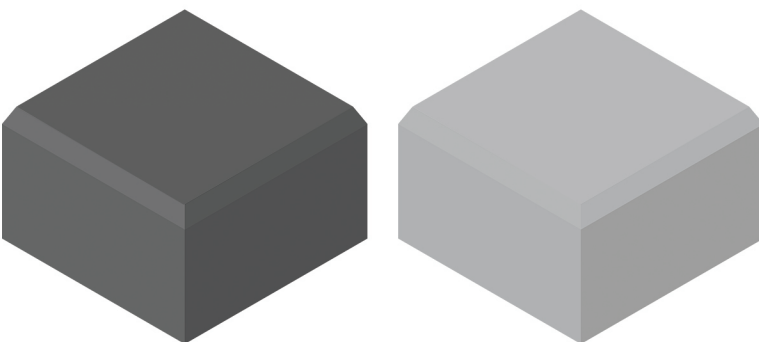

GRAPHITE

GRAY

LIGHTWEIGHT & EASY TO INSTALL

One of the most advantageous aspects of Solicor-CR is its weight compared to other lab-grade worksurface materials. Solicor-CR boasts a much lower weight density in addition to its attractive color-through aesthetic and chemical resistant properties. Also it is a dream to install.

7.4
lbs per
square foot

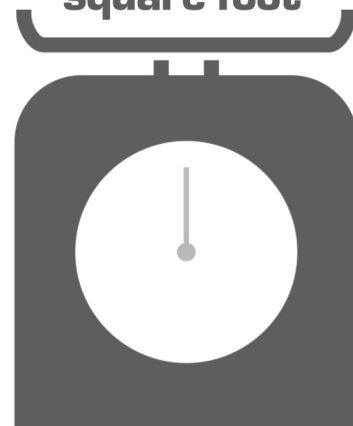

COLOR-THROUGH, COLOR-MATCH,
CHEMICAL RESISTANT WORKSURFACES

The Solicor-CR initial color offering includes our popular Graphite and Gray, both created specifically to match the Graphite and Gray seen on Durcon's full family of lab-ready materials. This opens up a new world of laboratory design, with color-matched surfaces in all of the following Durcon product lines:

EPOXY RESIN
GREENSTONE
SOLID PHENOLIC COMPACT (SPC)
SOLICOR-CR

SOLICOR-CR

worksurfaces

Materials Comparison

Material	Chemical Resistance	Heat & Fire Resistance	Moisture Resistance	Impact & Scratch	Lab Durability
Solicor-CR	✓	✓	✓	✓	✓
Solicor Standard	—	—	✓	—	—
SPC-CR	✓	—	✓	✓	✓
SPC Standard	—	—	✓	—	—
Solid Surface	—	✗	✓	✗	—
High Pressure Laminate [HPL]	—	✗	✗	—	✗

Test Results Summary

FIRE TESTING RESULTS RATED: CLASS A



Time to Ignition	=	28.8 sec
Max Flamespread Distance	=	6.74 feet
Time to Max Spread	=	7 min 27 sec

CHEMICAL TESTING SUMMARY



ITEMS	NO. REAGENT WITH 3 RATINGS
Volatile Subtotal	0
Non-volatile Subtotal	0

Exceeds Requirement of No More than Four (4) Level 3 Conditions

PHYSICAL TEST RESULTS



Standard	Results
Dry Heat Resistance	Rating 5 (Best)
Radiant Heat Resistance	284 Seconds
Large Ball Impact	1981 MM
Moisture Absorption	1.07%
Scratch	5 Newtons
Lightfastness Fade	Rating 4

Samples & Orders

To request samples of Solicor-CR, reach out to your regional Durcon representative or contact our Customer Service team using the info below:

✉ samples@durcon.com
☎ 1-512-595-8000

Or visit us online at www.durcon.com

Certifications & Memberships



FSC [Forest Stewardship Council] certification for Solicor-CR is available upon request, at time of placing order.